

162
149 311

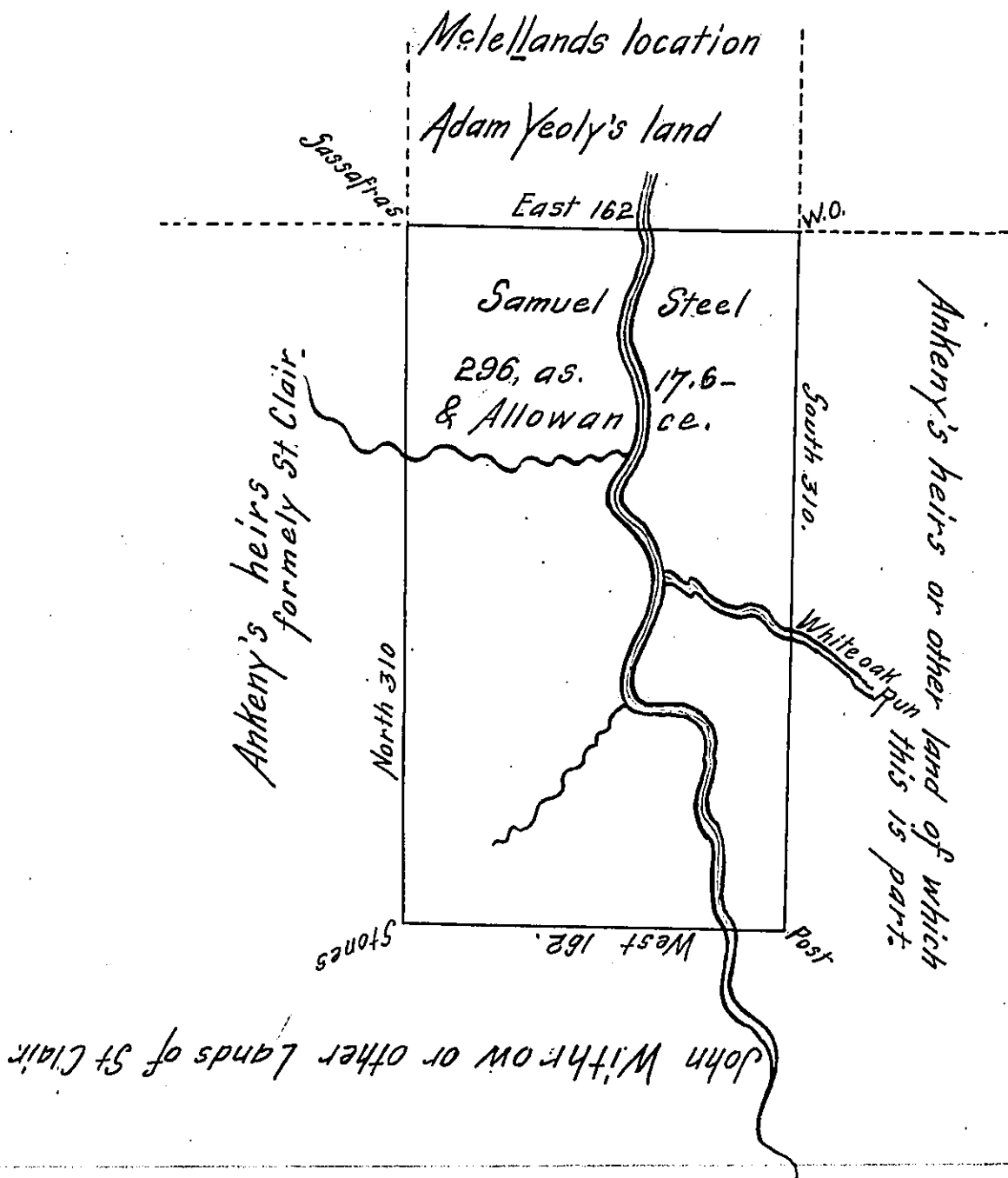

In pursuance of an Application granted to Samuel Steel No. 1052, bearing date 3^d of April 1769, Surveyed on the 19th of January 1829, containing two hundred and ninety six acres, seventeen and six tenths ^{perches}, and the allowance proportioned at six percent for roads &c. Situate on the Loyalhanna creek near the meeting of the waters that form said creek including the noted lick in the bottom in Donegal Township, Westmoreland County Pa.

Gabriel Hiester Esqr.

S. L. Carpenter, D. S.

Surveyor General of Pa.

Note - The above survey is within the limits of a survey made for Gen. St. Clair on order No. 19, granted on the 9th of February 1769, containing 412 as. 15 p^{rs}. This and the part that A. McLeland is laid on, all belonged to St. Clair and all now patented. S. L. C.

IN TESTIMONY that the above is a copy of the original remaining on file in the Department of Internal Affairs of Pennsylvania, made conformably to an Act of Assembly approved the 16th day of February, 1833, I have hereunto set my Hand and caused the Seal of said Department to be affixed at Harrisburg, this twenty eighth day of July 1908.

Henry Fowler
Secretary of Internal Affairs.